



French Face Plate 45° Type, 45 x 45mm

Technical Features

Angle Modular Insert, with jack shutter

Outer dimension: 45 x 45 x 27.5mm

Color: RAL9010 white

Technical Drawings

NF0011

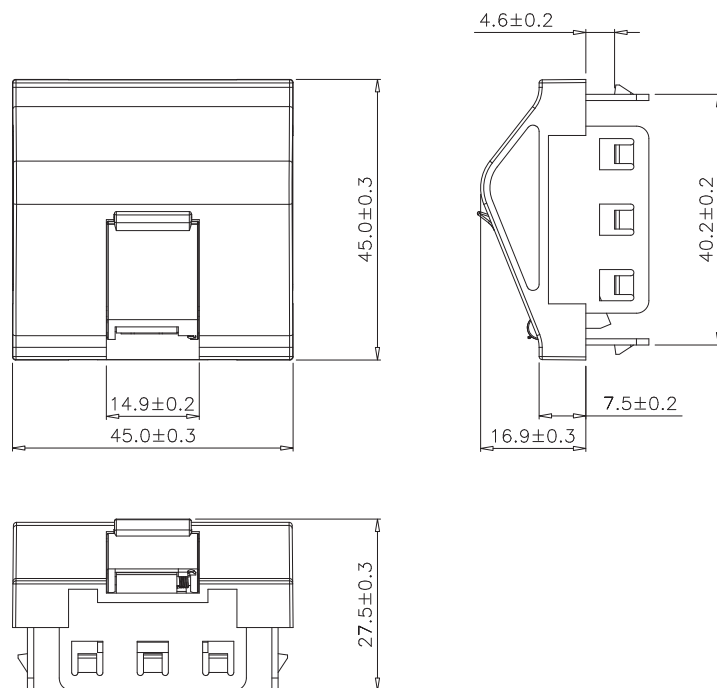

www.logilink.de



RoHS
compliant



NF0012

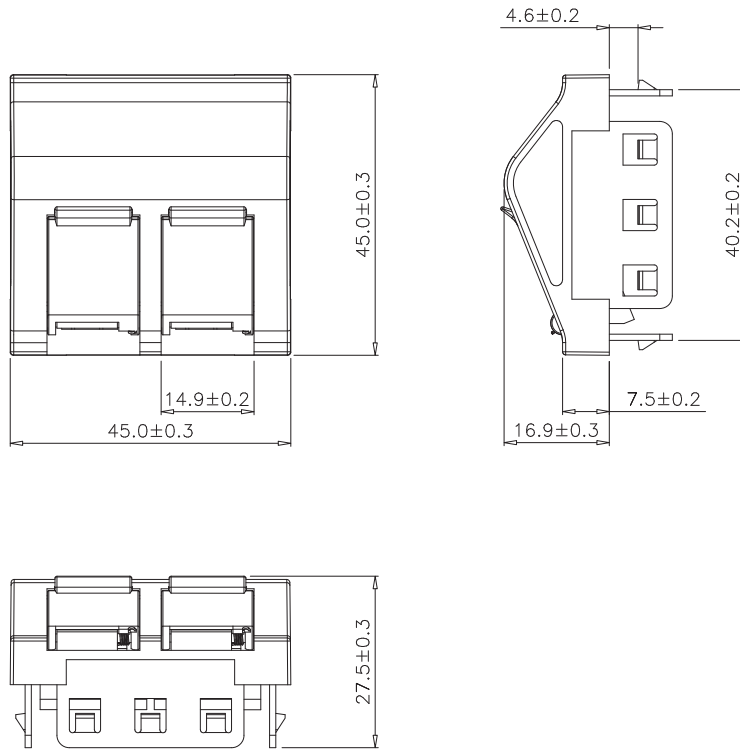

| Part no. | Number of Ports | EAN Code |
|----------|-----------------|---------------|
| NF0011 | 1 port | 4052792045079 |
| NF0012 | 2 ports | 4052792045086 |

Package Contents

French Face Plate 45° type, 45 x 45mm x 1

Packaging Informations

| | |
|-------------------|--|
| Packing Dimension | 80 x 115 x 0.04mm |
| Packing Weight | 0.0125kg (NF0011) / 0.01575kg (NF0012) |
| Carton Dimension | 465 x 465 x 310mm |
| Carton Q'ty | 400pcs |
| Carton Weight | 5kg (NF0011) / 6.3kg (NF0012) |

www.logilink.de



RoHS
compliant

